



# RSP-SERIES

The RSP-Series is designed to handle concrete structures and concrete waste. The Rotar Static Pulverizer produces enormous power to handle all concrete demolition and secondary processing work

The RSP Series is fitted with replaceable and interchangeable cutting teeth. That are designed to fracture and downsize the concrete with ease. The RSP is also fitted with rebar and steel cutting blades in the throat. The RSP's body is made from high-strength wear-resistant materials, making it extremely strong and durable.

Replaceable and Interchangeable Cutting Teeth

Rotar's proprietary high performance speed valve senses automatically when the need to switch from speed to power mode is required.

Specially Developed Speed Valve

The position of the hydraulic cylinder is designed at an optimum angle that ensures constant power and material penetration for maximum efficiency.

Hydraulic Cylinder



RIDE  
WITH  
US



# Specifications

The RSP-Series will work its way through any concrete project with ease by incorporating its features of a high pressure cylinder and durable replaceable and interchangeable wear parts.

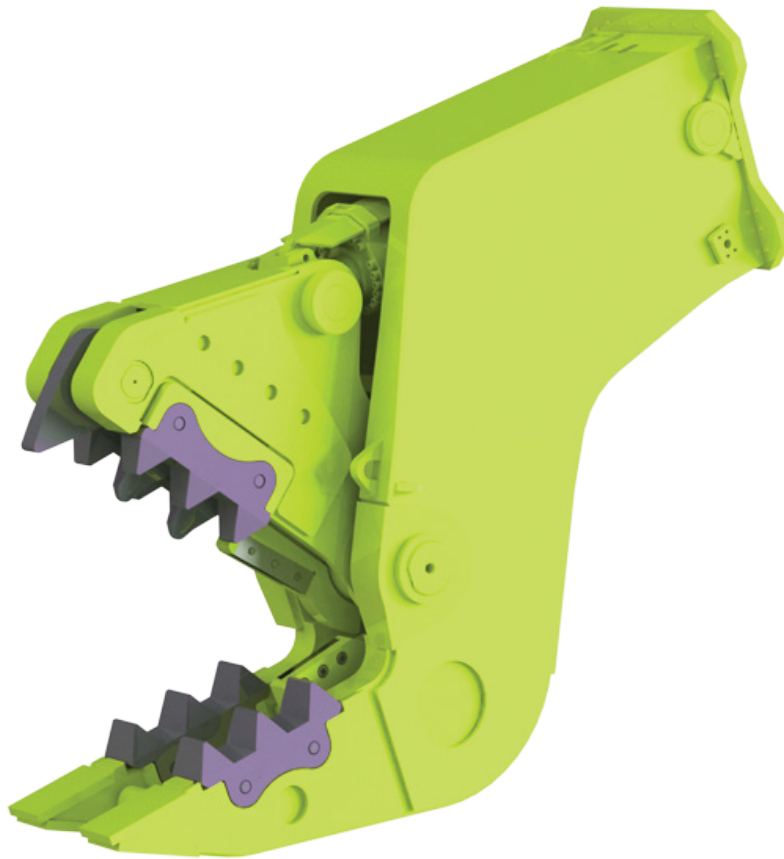

Specification	Unit	RSP-SERIES		
		25 S	30 S	40 S
Force @ Mid-Jaw	ton	105	127	155
Carrier Weight / Stick	ton <sup>^</sup>	20-30	25-35	35-50
Weight	lbs	5,170	6,990	9,040
Opening Max	in	34	40	46
O.A.L.	in	95	107	124
Hydraulic Flow Max.	gpm	40-66	40-66	40-80
Operating Press Max.	psi	5,075	5,075	5,075

<sup>^</sup>metric ton